

# Thin Brick



What's inside

- 1 – Thin Brick Collection p<sup>9</sup>
- 2 – Installation Guide p<sup>21</sup>

Real, authentic bricks –  
expertly manufactured or  
cut down to easy-to-install  
facings. The perfect answer  
for fast renovations and  
impressive features.





# Transform any space with the beauty of brick

## A new and easier way

Enhance your home in a weekend with the lightweight and easy to install Thin Brick. Our new range of slimline brick facings allow you to bring the effortless and authentic style of bricks to almost any space.

## The Thin Brick advantage:

- |  |  |  |
|--|--|--|
| <b>1.</b>  | <b>2.</b>  | <b>3.</b>  |
| <b>Design flexibility</b><br>Our versatile slim brick format helps you realise your creative vision and transform any space inside or out. | <b>Broad choice</b><br>Choose from Austral Bricks entire range of colours and textures to match your style and design. | <b>Time-saving</b><br>Assemble in no time with simple adhesive fixing. |





# More impact with less effort

---

## Thinner profile. Better results.

Because Thin Brick is genuine brick only thinner, it gives you more flexibility to add style and authenticity to any part of your home, reducing the cost and time that it would take for standard brick applications.

## Where to use Thin Brick

Striking splashbacks, statement walls and arches, cosy fireplaces, regal wine cellars, inviting outdoor entertaining areas, exquisite floors and more, are all possible with Thin Brick.





# Thin Brick Collection

- Bowral Bricks
- La Paloma
- San Selmo Classico
- San Selmo Smoked





**Bowral 76**

These distinctive dry pressed bricks made in Bowral, New South Wales, since the early 1900's. Bowral Bricks have featured in many of Australia's most admired and awarded architectural designs.

Their sharp edges and inherent character combine with the distinctive Bowral clay colours to create what can only be a Bowral Brick.

Made in NSW

**Colours**



Bowral Blue



Brahman Granite

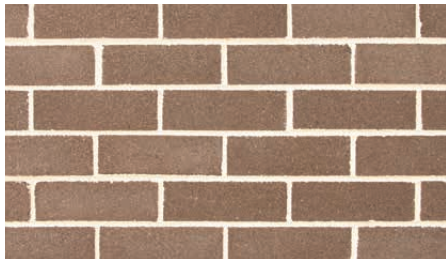

Murray Grey



Chillingham White



Simmental Silver

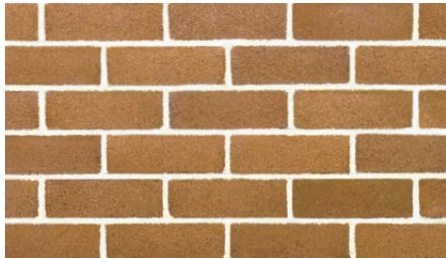

Hereford Bronze



Bowral Brown

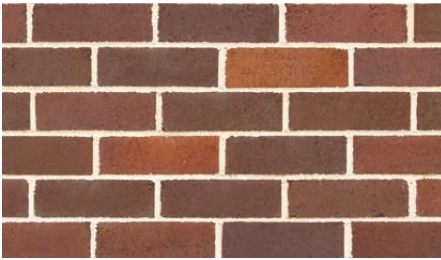

Renovation Gertrudis Brown

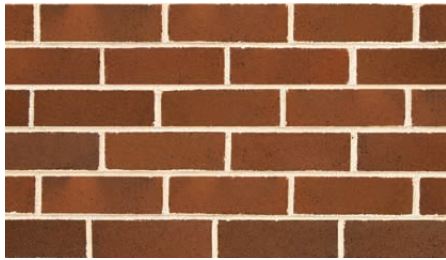

Gertrudis Brown

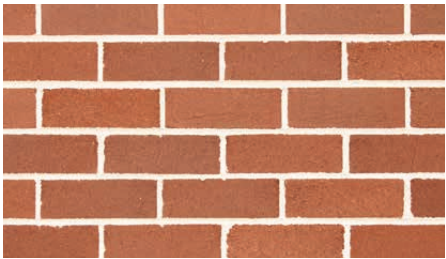

Capitol Red

\*Bowral Brick facings are available in both a 50mm and 76mm format.

BOWRAL BRICKS





**La Paloma**

Spain – confident, creative and the artistry of Dali, Picasso, Miró, which give inspiration to the soft white and charcoal black bricks of La Paloma and La Paloma Rustico. Characterful, eye-catching and steeped in heritage, they express two striking colours found in the spectrum of fired clay colours, transforming buildings into works of art.

**Colours**



Castellana



Miro



Azul



Romero





**San Selmo Classico**

Inspired, rustic and charming. The unique San Selmo range embodies the beauty of brick. The San Selmo range suits all contemporary projects and environments.

**Colours**



Original



Limewash



Aged Red





**San Selmo Smoked**

The San Selmo range of Smoked bricks encapsulate the inherent beauty of brick. With hues that transition from light to dark and subtle tactile finishes, the San Selmo range suits a vast range of project styles.

**Colours**



Cloudy Silver



Grey Cashmere



Opaque Slate



Wild Storm





# Thin Brick Collection Overview

Highly suited for internal applications and hard to access areas, the Thin Brick range is an intelligent and cost-effective solution that delivers both functionality and beauty.

### Types



Standard Face – Size: 230 x 76 x 22mm



Corner Tile – Size: 230 x 110 x 76

### Bowral Bricks



Bowral Blue



Brahman Granite



Murray Grey



Chillingham White



Simmental Silver



Hereford Bronze



Bowral Brown



Renovation Gertrudis Brown



Gertrudis Brown



Capitol Red

### La Paloma

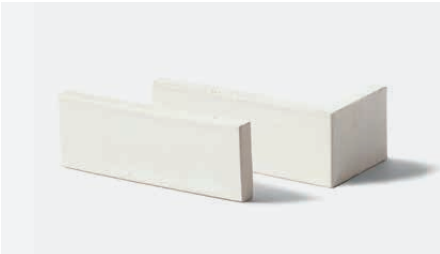

Castellana



Miro



Azul



Romero

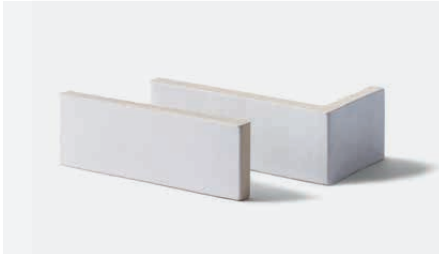

Glazed White



Glazed Black

### San Selmo Classico



Limewash



Original



Aged Red

### San Selmo Smoked



Grey Cashmere



Cloudy Silver



Opaque Slate



Wild Storm

Any brick in the Austral Bricks range can be made into a Thin Brick. Enquire with us today.





# Installation Guide

2



# 5-step installation guide

—



## 1. Prepare

The brick facing and substrate must be clean & free from form oil, curing compounds, laitance, dirt or any other surface contaminants. Extra care should be taken to ensure the substrate is fully dry and sufficiently cured.

For porous surfaces, primer should be applied as per the adhesive manufacturer's instructions to allow sufficient time between priming and installation.



## 2. Apply

Apply adhesive and brick cladding working from the bottom up, or from the top down. Working from the top down may help avoid splashing previously applied Thin Brick with dripping mortar.

Adhesive should be applied with a notched trowel using a scraping motion, ensuring the compound bonds effectively with the substrate.

Only apply as much adhesive as can be covered within 5 to 10 minutes or while adhesive surface is still wet and tacky. For small areas, a pre-mixed adhesive may be used.



## 3. Mortar

For mortar joints, an additive can be added to thicken the mortar mix when a pointing gun is used to fill the joints. Alternatively, pre bagged grouts, suitable for wide joints, can be used and trowelled into the joints.



## 4. Cleaning

Care must be taken to avoid smearing mortar on to the thin brick surface. Accidental smears or mortar droppings should be removed using a whisk broom or stiff bristled nylon brush after the mortar has become thumb print dry. A wet brush or sponge should never be used.





# 5. Sealing

Sealing of brickwork is not necessary and generally not required. However, for brickwork that is not protected or used as flooring, sealing is recommended to prevent potential discolouration and staining. Always apply a test patch a small section to determine the suitability of the product.



## Install Checklist

**The essential items you'll need**  
Here's our list of essential items you'll need to get going with Thin Brick:

- 20L pail
- Notched tile trowel
- Mortar shaping dowel
- Brick brush
- 10mm spacers
- Adhesive
- Pointing/grouting/hopper gun





# Easy installation options

One of the many beauties of Thin Brick is the variety of methods available when it comes to installation – ones that do not require a skilled labourer.

### Typical Installation Details

#### Masonry wall example

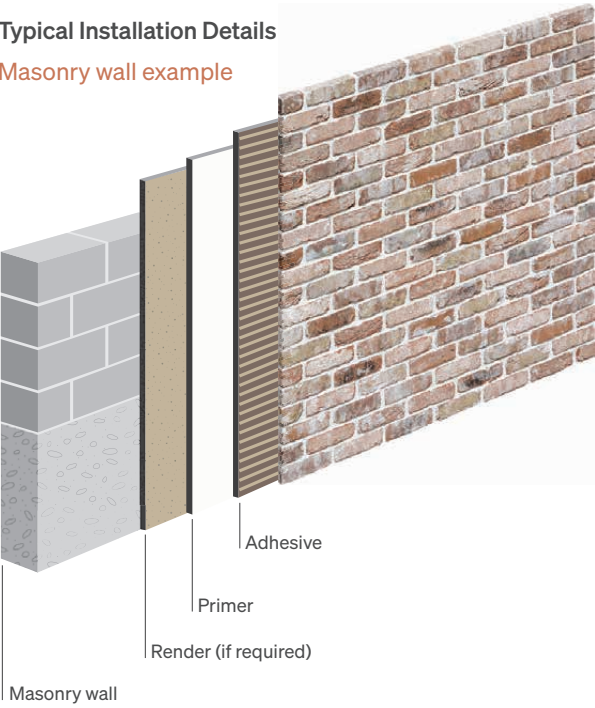

\*only required for external and wet area applications

### Preparation

To ensure an everlasting and striking appearance of your brick facings the following best practices should be adopted. The brick facings and substrate should be clean and free from any loose particles and surface contaminants. Extra care should be taken to ensure the substrate is fully dry, cured and free from any foreign material such as oil, release agents or dirt, prior to installation.

For porous surfaces such as fibre cement, priming may be necessary. For off form concrete, surface preparation can include grinding or abrasive blasting to achieve an open pored structure suitable for adhesive bonding.

Adhesive fixing the facings to the substrate is recommended by Brickworks for installations up to 3.5m. For applications over 3.5m the use of support angles or mechanical fixing is recommended.

There are many adhesives available and the most suitable is dependent on the specific requirements of each project. Variables to consider include the height, service conditions, substrate type and installation technique.

The following products are available from major tile retailers or large hardware stores. Always consult with the manufacturer to check the suitability of the adhesive for the substrate type and service conditions.

#### Stud wall example

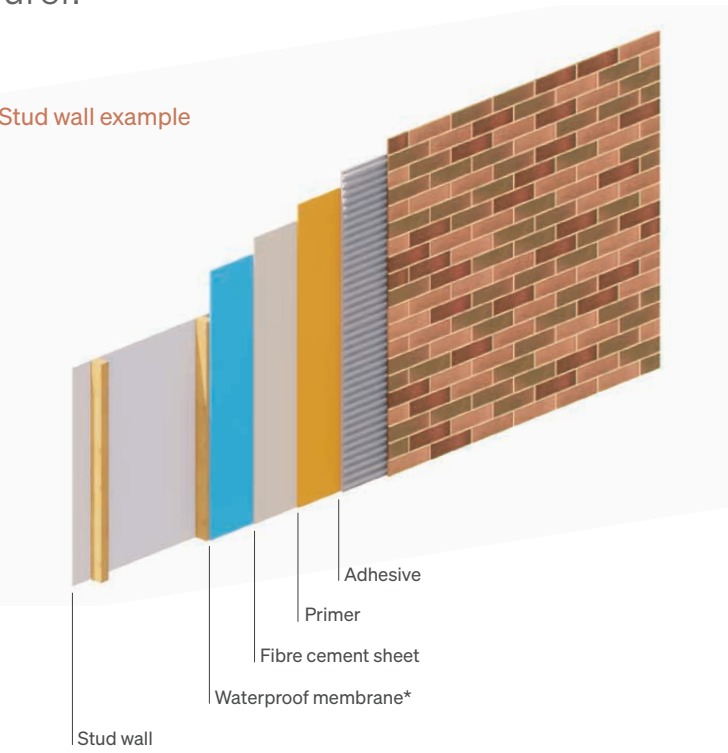

### Adhesives for Brick Facing Applications

#### Dry Areas

- Ardex X77
- Dunlop Universal Tile Adhesive
- Davco SMP Evo
- Bostik Ultramastik

#### Wet External Areas / Wet Internal Areas / Fibre Cement Boards

- Davco SMP Evo + Davelastic
- Ardex X77 + E90 Additive
- Dunlop Universal Tile Adhesive + Primer & Additive
- Bostik Evoflex

#### Metal and non-porous substrates

- MAPEI Keralastic T
- Ardex Optima
- Laticrete Latapoxy 300

#### Recommended Sealants

- Stain Proof (Dry Treat) 40SK Consolidator and Water Repellent
- Guard IT Solutions Porous or Dense Stone Sealer
- CHEMFORCE Fortifier Plus
- Actichem Defender WB or CSD 50

### Limitations

- Mechanical fixing must be used where brick facings exceed 3.5m in height.
- Adhesive fixing is not recommended for brick facings onto Blueboard and plasterboard.
- Precast concrete panels may contain release agents or a densified paste layer. The adhesive manufacturer should be consulted for preparation guidance and may require a suitable primer system.

### Mortar Joints

Standard mortar or pre-bagged grouts suitable for wide joints can be pointed or trowelled into the joints.

For improved workability, hydrated lime and adequate mixing is the best option. Additives such as water thickeners or plasticisers can also be used sparingly. Care needs to be taken to avoid smearing mortar onto the brick face to minimise staining and reduce cleaning efforts.

### Flooring

Thin Brick facings can be used for internal and external floor surfaces when laid on a solid concrete slab. When selecting your brick colour, careful consideration should be given to slip resistance, hardness and durability. A sealant should also be applied for a long lasting and maintenance free surface.

For best practice, installations should be in accordance with AS 3948 Installation of Ceramic and Stone Tiles and also the [Think Brick Brick Floors Fact Sheet](#).

For further details, of suitability of brick, please get in contact with the Austral Bricks team.





Dimensions

Facing Unit  
230L x 76H x 22mm Thick

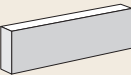

Corner Unit  
230L x 76H x 110W Thick

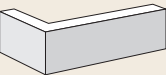

Laying Patterns

A bond refers to the pattern in which bricks are laid.  
The most common bond used is Stretcher Bond.

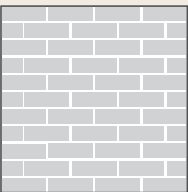

Stretcher Bond

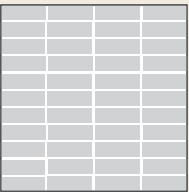

Stack Bond

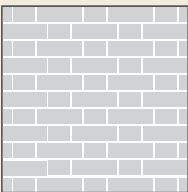

Flemish Bond

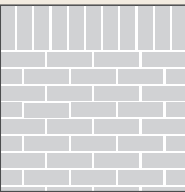

Soldier Course with  
Flemish Bond

Common Mortar Joints

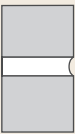

Shallow Ironed  
(Rolled)

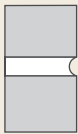

Deep Ironed  
(Rolled)



Struck Flush



Weather Struck

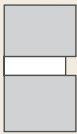

Raked

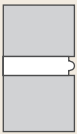

Beaded Pointing

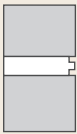

Tuck Pointing

Common Mortar Joints

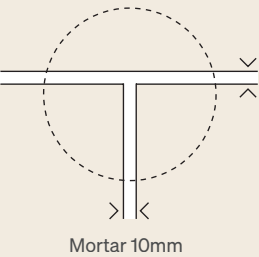

# General Information

Expansion, Movement  
and Control Joints

Existing expansion/control joints in  
substrate must be carried through  
the Thin Brick and shall conform  
to architectural details. Refer to  
AS3958.1 & 2 for more details.

Refer to architects & engineer's  
drawings for full details on expansion,  
control, isolation or movement  
joints. (Do not lay facings, screed or  
render over construction joints).

Efflorescence

Efflorescence is a water-soluble salt  
that is deposited on the surface of  
masonry products by the evaporation of  
water from the wall. On rare occasions  
efflorescence will occur on Thin Brick®  
cladding. Efflorescence will fall away  
naturally over time but can be removed  
more quickly using a stiff nylon bristle  
brush when the Thin Brick and mortar  
are completely dry. Do not attempt to  
wash or spray the efflorescence. This  
merely dissolves the salt and allows it to  
enter the brick only to re-emerge later.

Sealers

Sealers are not necessary on Thin Brick  
cladding. However, some customers  
use sealers to help prevent staining in  
applications prone to graffiti, smoke, soot  
and dirt. If you choose to use a sealer,  
make sure it is a breathable sealer. Take  
note that some sealers may darken the  
colour of the bricks. For information  
regarding actual performance or  
application of sealers, contact the  
manufacturer of the sealer directly.





# Discover More

---

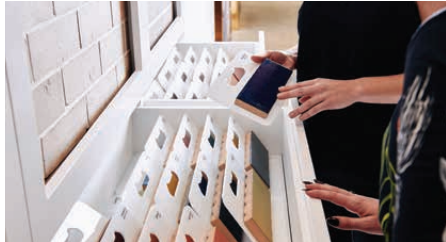

## Discover

---

**Brickworks Design Studios**  
Your local Brickworks design studio is a one-stop destination for advice and inspiration, and where you can experience the quality of our product range first-hand. Our experienced consultants will guide you through the range and help you find the best possible solution for your project – within your budget.

Call.  
13 Brick

## Create

---

**iVisualise Tools**  
Using Artificial Intelligence and digital technology, you're now able to experience colours, forms and profiles with our online colour visualisation tool. iVisualise helps make selection seamless and simple – whether you're looking for a more traditional product, or something more contemporary.

Visit.  
[brickworks.com.au/ivisualise](http://brickworks.com.au/ivisualise)

## Learn

---

**Colour Consultations**  
Building or renovating a home is a major investment – and it should be an enjoyable experience for you. We can help with a one-to-one colour consultation where our experts can guide you on colour trends, the right fit and style, and ideas that will give you a genuinely individual look.

Book.  
[brickworks.com.au/colour](http://brickworks.com.au/colour)





# Backed by Brickworks

Local expertise. Global quality. Brickworks is one of Australia’s biggest building material manufacturers. With heritage going all the way back to one of Australia’s founding brick producers, we’re proud of our reputation for design, innovation and sustainability.

## BRICKWORKS

### AUSTRALIA

australbricks®

australmasonry®

bristiler roofing®

southern cross cement®

BOWRAL BRICKS

DANIEL ROBERTSON

NUBRICK

GB Masonry

URBANSTONE®

CAPITAL BATTENS

Glen-Gery

### NORTH AMERICA

Glen-Gery

BRICKWORKS  
SUPPLY CENTER

### NEW ZEALAND

australbricks®

australmasonry®

BOWRAL BRICKS

GB Masonry

URBANSTONE®

### INTERNATIONAL BRANDS EXCLUSIVE TO BRICKWORKS

La Escandella  
ROOFING THE WORLD

S.ANSELMO  
vivere la differenza

la paloma  
cerámicas

TEJAS BORJA  
Since 1899





# Get in touch

—  
For more information, advice  
and samples get in touch  
with the Austral Bricks team.



Visit. [brickworks.com.au](https://brickworks.com.au)  
Call. 13 Brick

Design Studio

**Sydney**  
Tel. 02 9611 4200  
2 Barrack Street  
Sydney NSW 2000

Design Centres

**Albion Park**  
Tel. 02 4257 1566  
45 Princes Highway  
Albion Park NSW 2527

**Canberra**  
Tel. 02 6143 2400  
7 Lithgow Street  
Fyshwick ACT 2609

**Beresfield**  
Tel. 02 4944 6200  
2 Yangan Drive  
Beresfield NSW 2322

**Coffs Harbour**  
Tel. 02 6652 3457  
27 Lawson Street  
Coffs Harbour NSW 2450

**Bowral**  
Tel. 02 4861 3031  
Lot 1 Oxleys Hill Road  
Bowral NSW 2576

Head Office

**Horsley Park**  
Tel. 02 9830 7777  
Oakdale East Industrial Estate  
2 Latitude Road  
Horsley Park NSW 2175

Follow Us





Visit. [brickworks.com.au](http://brickworks.com.au)

Call. 13 Brick

A BRAND OF

**BRICKWORKS**

